

tala[®]

EU/UK USER GUIDE

Voronoi I – Walnut Knuckle Table Lamp

Thoughtful lighting, responsibly designed in London.

Thank you for making the switch to Tala.
Discover the full Tala family at tala.co.uk

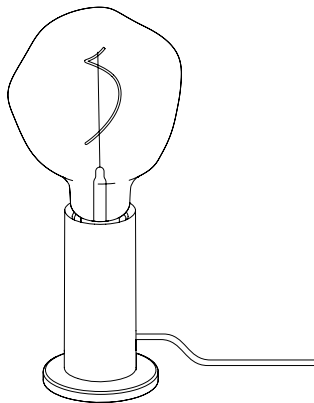

BEFORE STARTING

Please read instructions thoroughly before installation and keep them for future reference.
Please take extreme care when dealing with electrical equipment.

IMPORTANT

We recommend pairing with one of Tala's superior LED bulbs.
25W Max LED; 75W Max Incandescent; do not use with Sphere bulb bigger than 200mm
Bulb must be installed in fixture before turning on.

WARNING

Ensure power is turned OFF before inserting plug.

CARE AND CLEANING

We recommend cleaning with a soft dry cloth. Do not use abrasive materials as these will damage the finish of the product.

WARRANTY AND AFTER-CARE

This product has a three-year warranty. If there appears to be a functional defect with the product during this time, please contact our team at customerservice@tala.co.uk.
The external flexible cable or cord of this luminaire cannot be replaced; if the cord is damaged, the luminaire shall be destroyed.



IP20

220 - 240V



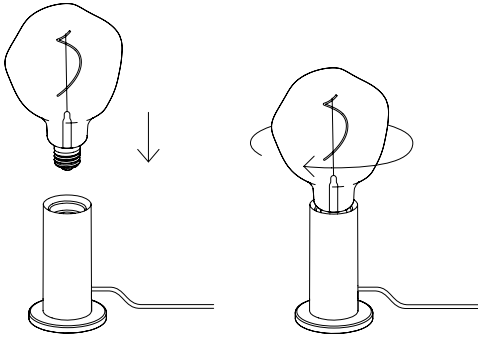

STEP 1

Insert your bulb into the top of the lamp, rotating clockwise until tight. Take care not to tighten too much to avoid breakage.

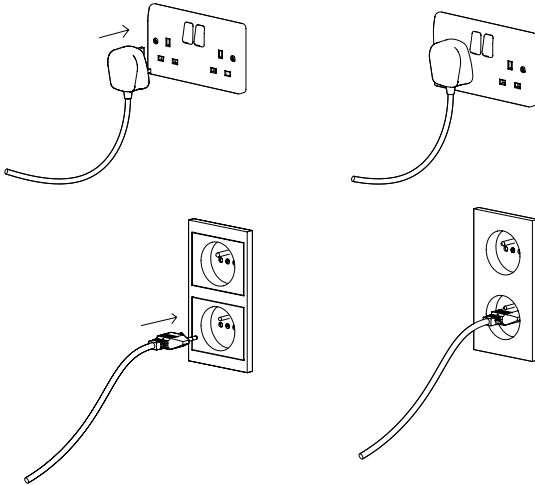

STEP 2

Insert the lamp plug into your chosen wall socket, making sure the power is switched off.

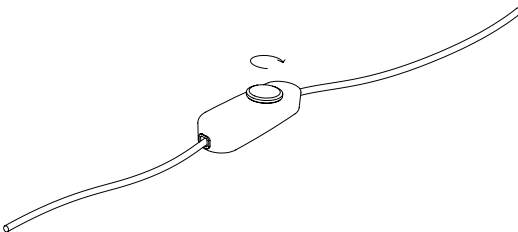

STEP 3

Switch the power on and rotate the dial on your dimmer until the bulb lights up. Adjust the dimmer for your desired light output.

Join the Community

Instagram: @tala | Facebook: talaHQ | Pinterest: TalaLED | Tag: lighttoliveby
Tala Studios, 25B Vyner Street, London E2 9DG | +44 20 3026 3246 | hello@tala.co.uk